

RAILEASY™ FLUSH FITTING

316L STAINLESS STEEL

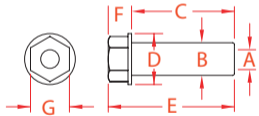

ITEM	A	B	C	D	E	F	G	QTY	WT
	(cable)								(lb)
C0981-P004-2	5/32"	0.37"	1.16"	0.57"	1.42"	0.26"	0.44"	2	0.06

NOTE:

The RailEasy™ Flush Fitting is perfect for architectural cable railing applications where “through post” hardware is desired for minimal obstruction. Self-locking mechanism holds cable in place. A tensioning device must be used at the opposite end of the cable run. Affix a Deluxe or HandiSwage™ Cover Nut Set (sold separately) to the end for a finished look.